

# LAJE FUNDO

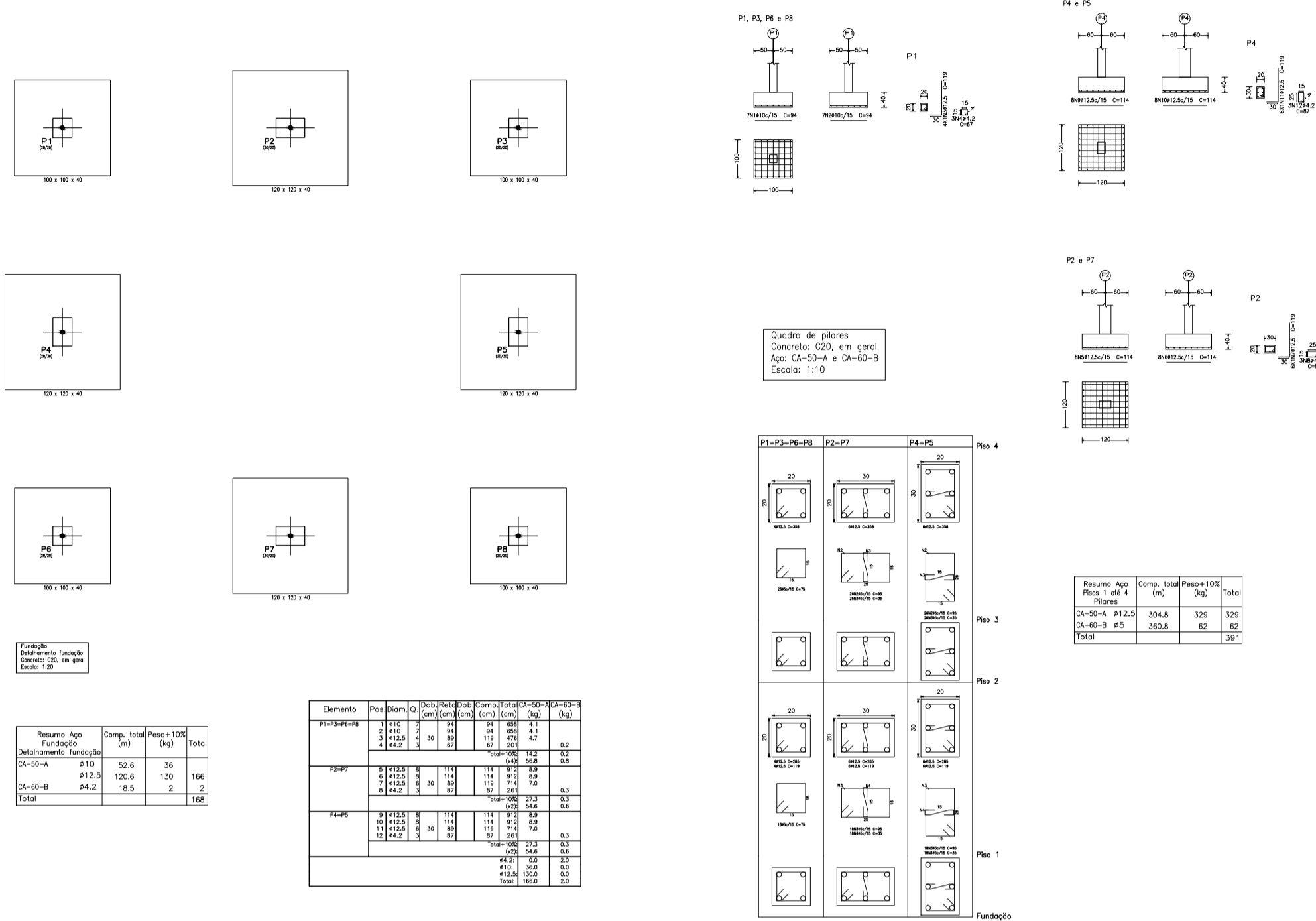

# LAJE FUNDO

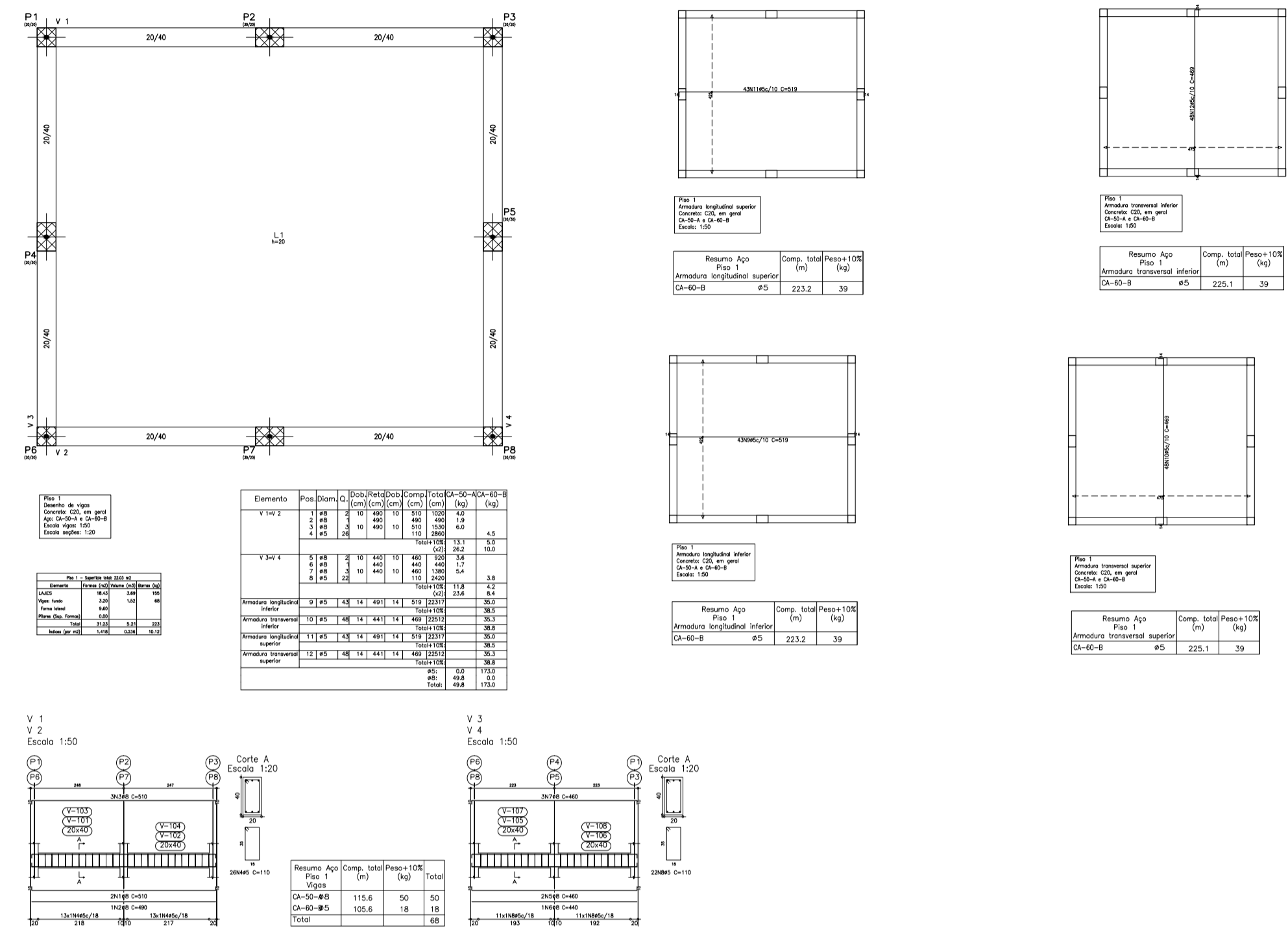

# CORTE

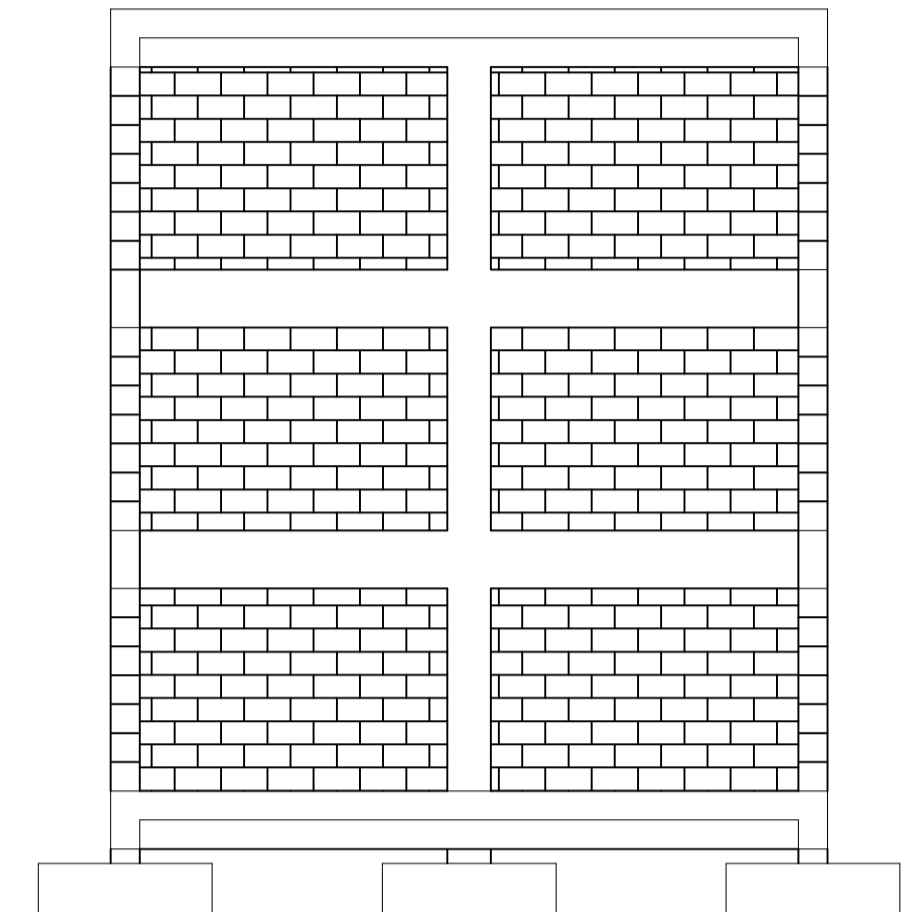

# LAJE TAMPA

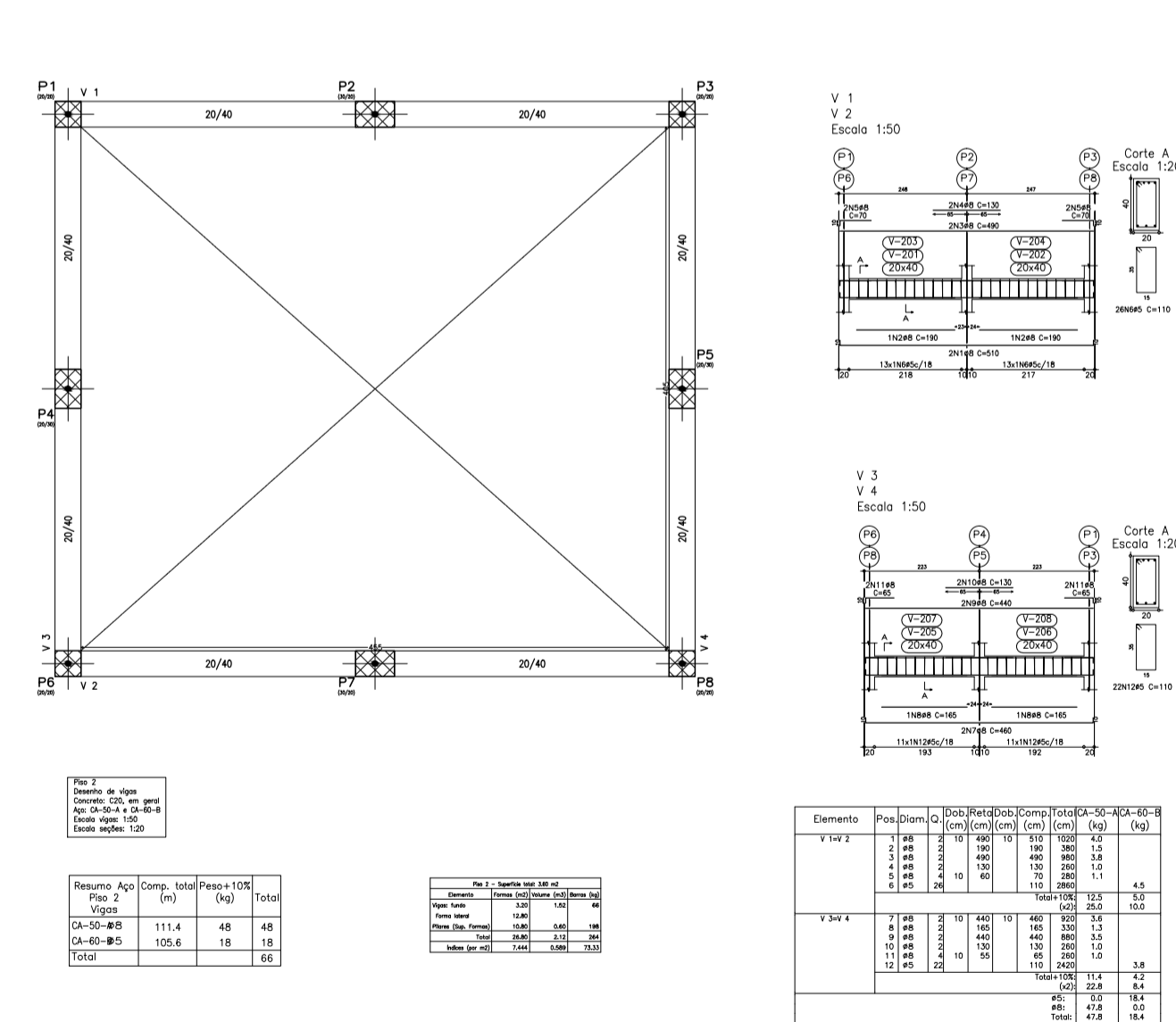

# LAJE TAMPA

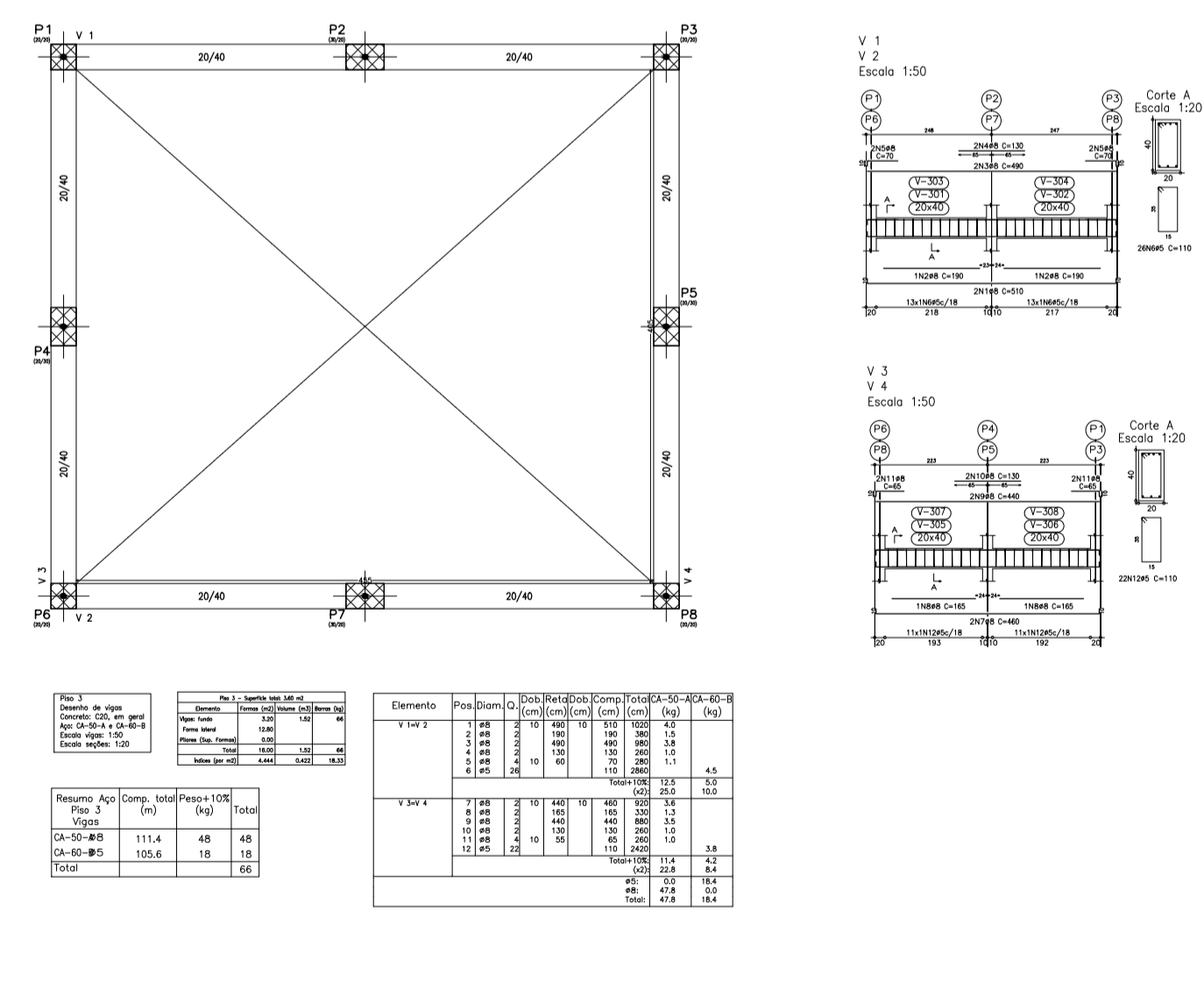

# LAJE TAMPA

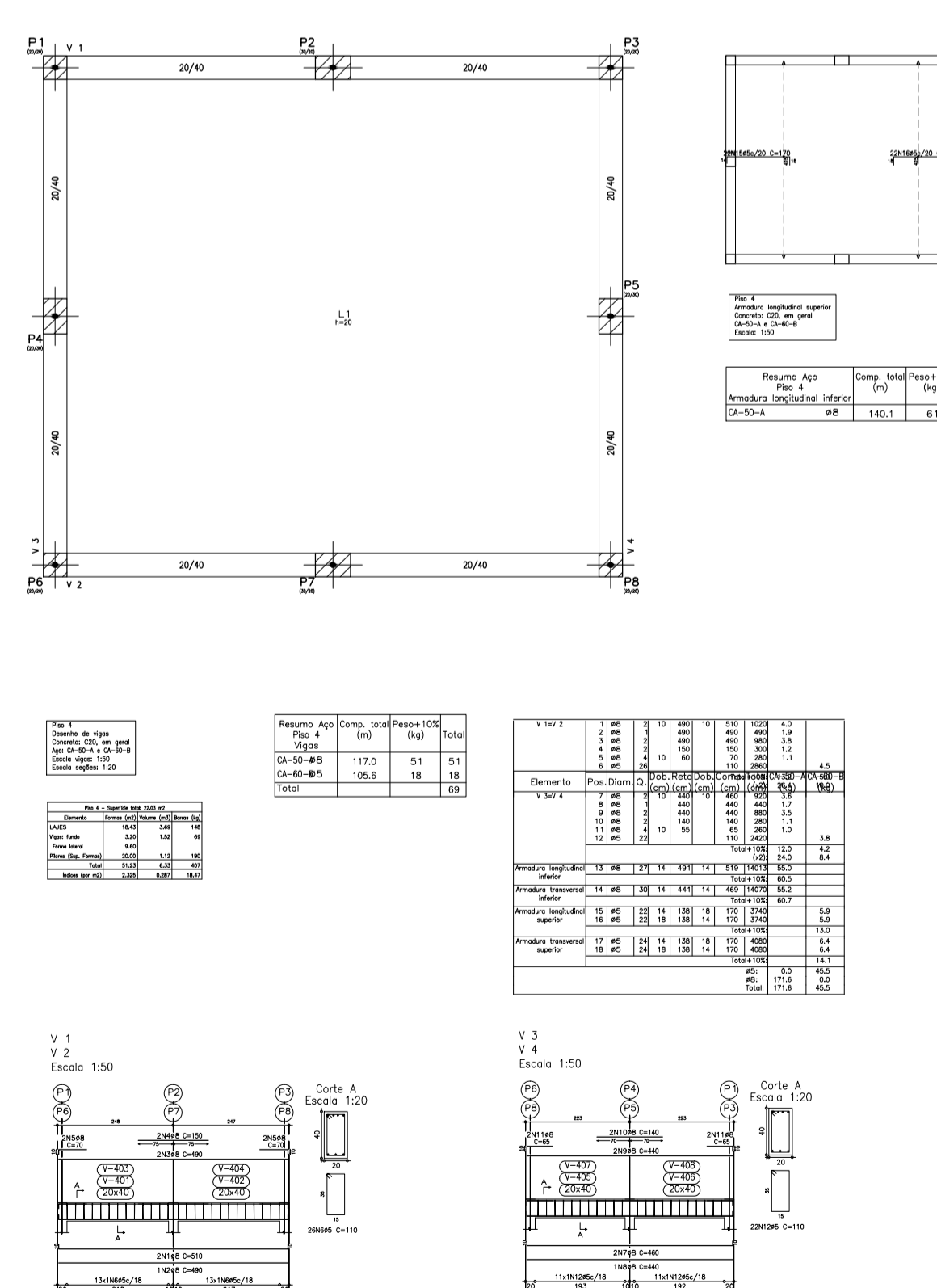

NOTA:

1. Aço CA-50-A e CA-60-B.

PARA USO DO REQUERENTE		CONSTRUTORA		PROJETO	
DEP. ENG.	CONTRATANTE	CONSTRUTORA	PROJETO	DEP. ENG.	CONTRATANTE
<p>JULIANA PINHEIRO BARBOSA</p> <p>Prefeitura Municipal de Entre Rios de Minas</p>		<p>REDE COLETORA DE ESGOTO</p> <p>Boirão Sossófrs</p> <p>Entre Rios de Minas - MG</p>		<p>ART CREAMG: 150.110/D</p> <p>GRUPO: Entre Rios de Minas - MG</p> <p>Escala: Sem escala</p> <p>Data: 10/06/2014</p> <p>FORMATO/FOLHA: A1:1/1</p>	